



CHEMICAL-RESISTANT
SQUARE-SHAPED HEAD FIBER

New

FT-Z8Y SERIES

Chemical-resistant square-shaped head with no light-beam misalignment.



Usable with Various Chemical Liquids

With the case made of PFA and fiber clad with PFA, the fiber can be used with various types of chemical liquids.

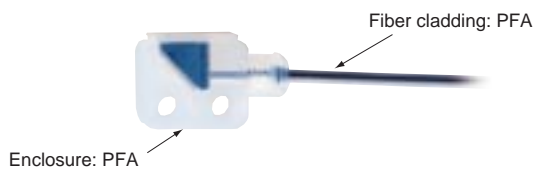

Easy Cutting of Even PFA Protected Fiber

As the diameter of the fiber, including the PFA protected portion, is only $\phi 2.2\text{mm}$, you can simply cut the fiber to a desired length.

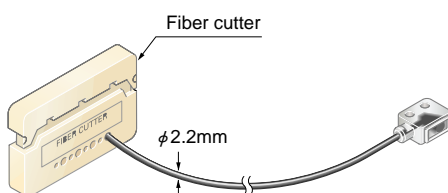

Excellent Explosion-proof Structure Complying with SEMI S2

Since the fiber does not have any electrical circuit in the sensing part, it offers an excellent explosion-proof structure.

Square-shaped Head Provides Easy Mounting

The square-shaped head offers both easy installation and easy light-beam alignment.

The head measures $7 \times 15 \times 13\text{mm}$, and can be mounted with M3 screws at two locations.



Thru-beam Type Side-View with 1,500mm Long Sensing Range

The compact side-view type unit realizes a long sensing range of 1,500mm.

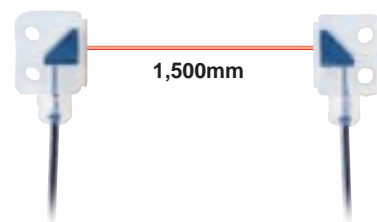

SPECIFICATIONS

Type	2m type	5m type	7m type
Item Model No.	FT-Z802Y	FT-Z805Y	FT-Z807Y
Applicable amplifier	FX-D1 series (Note)		
Sensing range	1,500mm		
Sensing object	φ4mm or more opaque object		
Allowable bending radius	R25mm or more		
Fiber cable length (Free-cut)	2m	5m	7m
Protection	Equivalent to IP67 (except for the cut ends of the fiber)		
Ambient temperature	0 to +60°C (No dew condensation or icing allowed), Storage: 0 to +60°C		
Ambient humidity	35 to 85%RH, Storage: 35 to 85%RH		
Material	Fiber cable	Fiber core: Acrylic, Sheath: PFA	
	Fiber head	Enclosure: PFA	
Accessories	FX-CT1 (Fiber cutter): 1 No.		

Note: For further details, refer to **FX-D1** series catalog or sensor general catalog for **FX-D1** series.

DIMENSIONS (Unit: mm)

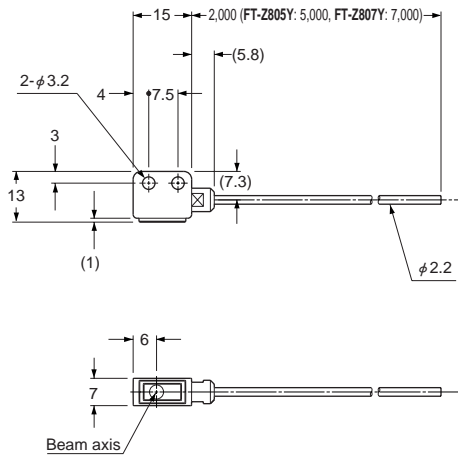

PRECAUTIONS FOR PROPER USE



This product is not a safety sensor. Its use is not intended or designed to protect life and prevent body injury or property damage from dangerous parts of machinery. It is a normal object detection sensor.

Mounting

- Mount using M3 screws. The tightening torque should be 0.3N·m or less.

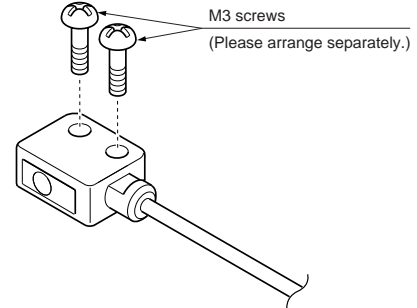

Cautions

- Keep the fiber head surface intact. If it is scratched or spoiled, the detectability will deteriorate.
- If the fiber head surface is dirty, wipe the off the dirt with a clean soft cloth moistened with water.
- Do not use the fiber head surface in places where it may come in direct contact with water. A water drop on the fiber head surface deteriorates the sensing. No dew or liquid drop is present on surface of fiber head surface or sensing object.
- Do not apply excessive tensile force of the fiber cable.
- Bending radius of the fiber cable must be R25mm or more. If the bending radius is smaller than the specified value, the sensing performance may deteriorate.
- Ensure that any strong extraneous light is not incident on the receiving face of the fiber head.
- The fiber cables should be cut off at the ends with the fiber cutter **FX-CT1**(accessory) before insertion into the amplifier. Carefully cut and connect the fiber, as the sensing performance may deteriorate depending on the conditions of the cut part and/or of the connection to the amplifier.

SUNX

All information is subject to change without prior notice.

<http://www.sunx.co.jp/>

SUNX Limited

2431-1 Ushiyama-cho, Kasugai-shi, Aichi, 486-0901, Japan
Phone: +81-(0)568-33-7211
FAX: +81-(0)568-33-2631

Overseas Sales Dept.

Phone: +81-(0)568-33-7861
FAX: +81-(0)568-33-8591

Printed on 100% recycled paper
PRINTED IN JAPAN